

FULLY EQUIPPED
innovative accessory solutions



WARN WINCH TABOR 9K

The Tabor 9K by Warn Industries comes with an automatic brake, 100 ft of wire rope, low-profile freespool actuator and a 3-stage planetary geartrain. It's a whole lot, for a whole little.



TABOR 9 SPECS

Part Number: 900560
Rated Line Pull: 9,000 lbs. (4080 kgs) single-line
Intended Use/Application: Vehicle Recovery / For Trucks and SUVs
Duty Cycle Rating: BEST ← LONGER → GOOD
Motor: Gen II, Series Wound
Remote Control: Remote switch, 12' (3.7m) lead
Geartrain: 3-Stage Planetary
Gear ratio: 216:1
Clutch (freespooling): Sliding Ring Gear
Brake: Automatic Direct Drive Cone
Drum diameter/Length: 2.5"/9.0" (6.4cm/23cm)
Weight: 89 lbs. (36.3kgs.)
Wire rope: 100', 5/16" diameter (30m, 8mm diam.)
Fairlead: Roller
Recommended Battery: 650 CCA minimum for winching
Battery leads: 2 gauge, 72" (1.83m)
Finish: Powder Coat

12V DC PERFORMANCE SPECS

Line Pull Lbs.(Kgs.)	Line Speed FT./min(M/min.)	Motor Current	Pull by layer layer/Lbs(Kgs.)
0	29.5 (8.99)	71 amps	1/9000 (4082)
2000 (910)	13.7 (4.18)	185 amps	2/8190 (3715)
4000 (1810)	9.5 (2.90)	277 amps	3/7500 (3402)
6000 (2720)	6.8 (2.07)	372 amps	4/7010 (3180)
8000 (3630)	5.1 (1.55)	464 amps	
9000 (4080)	4.5 (1.37)	508 amps	

Above performance specs are based on first layer of drum

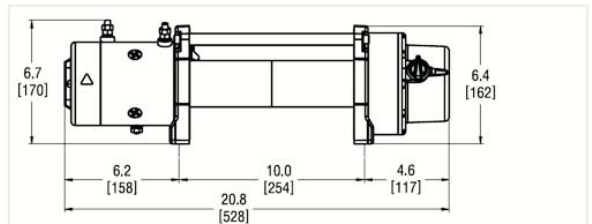

Winch Dimensions: 20.8" L. x 6.3" D. x 6.4" H. (528mm L. x 160mm D. x 162mm H.)
Mounting Bolt Pattern: 10.0" x 4.5" (254mm x 114.3mm)

TO PURCHASE THIS PRODUCT, CONTACT YOUR NEAREST FULLY EQUIPPED STORE
0800 111 000 WWW.FULLY EQUIPPED.CO.NZ

